

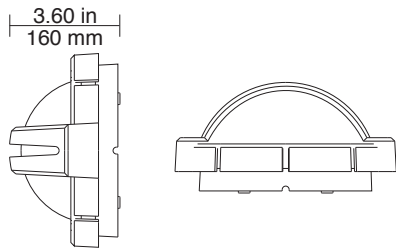

Mounting: S

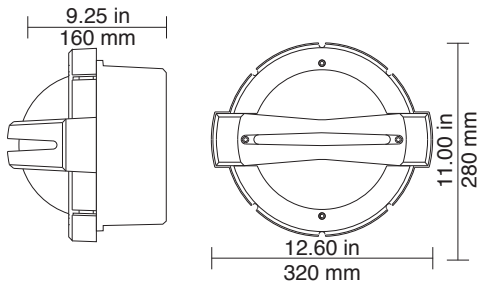

Mounting: SWB



LENS OPTIONS - OTHELLO

PO Polycarbonate Opal Lens

LIGHT SOURCES - OTHELLO

INC 60	Incandescent Medium Base A23 120v
CFL 18 to 32	Compact Fluorescent four pin base electronic ballast 120v, 208v, 240v, 277v, 347v
MH 50	Metal Halide Medium Base ED-17 HPF Magnetic 120v, 208v, 240v, 277v, 347v
HPS 35 to 50	High Pressure Sodium Medium Base ED-17 Magnetic 120v, 208v, 240v, 277v, 347v



The Vio High Power White LED source is now available for this luminaire. Vio LEDs provide a diffused, warm-white color that meets the high standards of lighting professionals. Vio LEDs feature minimal part-to-part color variation, with less than 100 Kelvin color shift over 50,000 hours of rated life. The result is stable, uniform light similar to a soft white incandescent lamp that enables lighting designers to create a look that lasts.

Call Barbican Architectural Products for details.



Othello

A413.2 aluminum alloy is used for strength, resistance to corrosion and reduced weight. Seven stage chromate surface treatment provides a permanent bond between metal and UV resistant polyester coating. 304, 316 stainless steel hardware Meets or exceeds UL 1598 for wet location. Call Barbican Architectural Products for details.

Combine your project with other similar designs in different sizes.

- Porto
- Newport

COLOUR OPTIONS - OTHELLO

STANDARD

BLK	Textured Black
BRZ	Textured Bronze
WHT	Textured White

PREMIUM

GRA	Textured Graphite
PAT	Patinated Green
RALG	Dark Green
SIL	Textured Silver

Custom Colours please contact the factory for TIGER DRYLAC color charts.
www.Barbican.ca or 1-800-663-5781

MOUNTING OPTIONS - OTHELLO

RIC	Recessed in Concrete (HID Sources)
RNIW	Recessed in non-insulated wall space (HID Sources)
S	Surface Mount (CFL & INC Sources)
SWB	Surface Wall Box (HID Sources)

noral